

AcousticLUX 5

TECHNICAL DATA SHEET

1000 x 1000mm

- Surface or suspended acoustic LED luminaire
- Light Distribution: Direct
- Optical System: Opal PMMA diffuser
- Housing: Steel
- Colour: White (RAL9003S), custom RAL available, see page 3 for options



ELECTRICAL DATA

Main Voltage:	220-240V, 0/50/60Hz
Power Factor:	>0,95
Integrated Sensor:	Available

System power*, W:	16.2w to 104.5w
Control gear:	ECG On/off or Dali

LIGHTING DATA

Luminaire output*,lm(ta+25°C):	3200lm TO 11700lm
CRI (Ra):	80+, CRI90 on request
SDCM:	3
Distribution Type:	Direct
UGR Index:	<19

System efficacy, lm/W:	Up to 111
CCT, K:	4000
Light Distribution:	Direct
LED lifetime, h:	50000/L80B10
Beam Angle:	116

TECHNICAL DATA

Dimensions, mm:	L1000 W1000 H150,H250,H400
Net weight, kg:	1.8 up to 7.7

Quantity in package, pcs:	1
---------------------------	---

STANDARDS

Operating temperature range, °C:	ta0...+35
Ingress protection code:	IP40

Mechanical impact resistance:	IK02
Certificates:	CE, ROHS

Note: Tolerance range for optical and electrical data: $\pm 10\%$. 4C LIGHTING SOLUTIONS is constantly developing and improving its products. The right is reserved to change any product specifications without prior notification.

TECHNICAL DRAWING

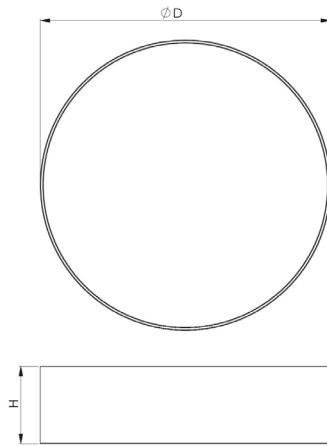

LIGHT DISTRIBUTION CURVE

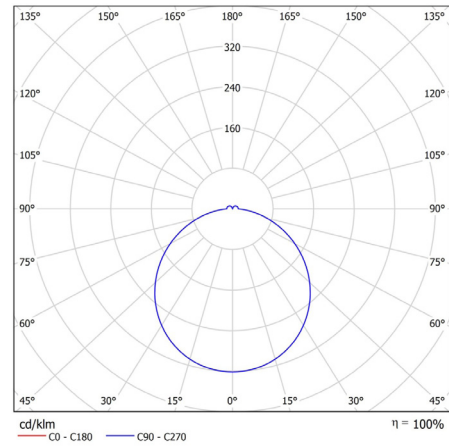

PRODUCTS

COLOUR (K)	LUMINAIRE OUTPUT (LLM)	POWER (W)	EFFICACY (LLM/W)	PART CODE
4000	8701	78.1	111	ACLX5/10101/8700/4K
4000	7496	78.1	96	ACLX5/10102/7500/4K
4000	8125	104.5	78	ACLX5/10104/8100/4K

OPTIONS

	PART CODE
DALI driver	/DD
3 Hour emergency	/E3S
3 hour DALI emergency	/E3D
4C MESH	/MM

	PART CODE
4C MESH with Sensor	/MMS
Integrated DALI sensor	/IDS
Custom RAL	/RAL

EXAMPLE PART CODE: **ACLX5/331/1600/4K/DD/E3D**

Note: Tolerance range for optical and electrical data: $\pm 10\%$. 4C LIGHTING SOLUTIONS is constantly developing and improving its products. The right is reserved to change any product specifications without prior notification.

Material Colour:



Note: Tolerance range for optical and electrical data: $\pm 10\%$. 4C LIGHTING SOLUTIONS is constantly developing and improving its products. The right is reserved to change any product specifications without prior notification.